

CHEROKEE COUNTY
ENTRANCE PERMIT APPLICATION

(circle one)
Culvert: Yes No

Township _____

Section # _____

Name _____
(Property Owner)

Address _____

City & Zip Code _____

Telephone Number _____

Date of Application _____

Entrance Location _____

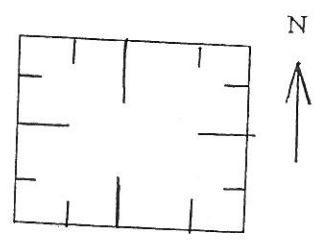

(Place Pink flags at fence line of proposed entrance location)

Reason for Entrance Request _____

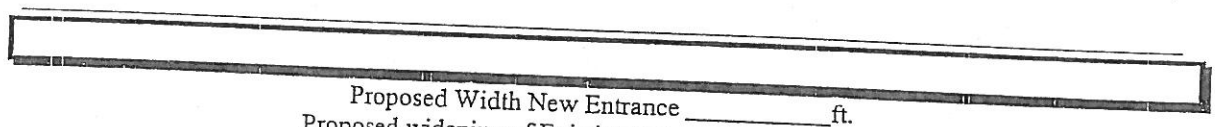

Proposed Width New Entrance _____ ft.

Proposed widening of Existing Entrance _____ ft.

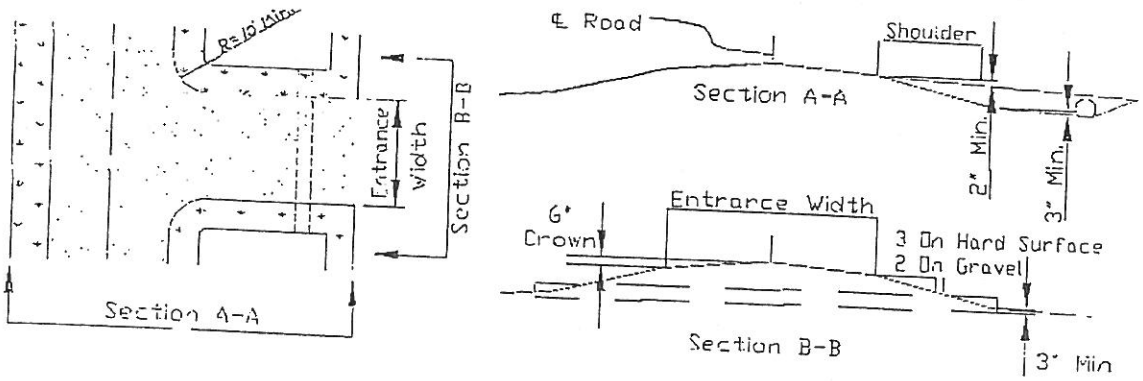

Maintenance Superintendent _____ Date _____

County Engineer _____ Date _____

Board of Supervisors _____ Date _____

The applicant agrees that if granted a permit to construct or widen an entrance, the following stipulations shall apply:

1. That the proposed entrance location must be approved by the County Engineer and the Board of Supervisors.
2. That the size and type of culvert must be approved by the County Engineer.
3. That the proposed entrance, including culvert pipe, shall be constructed by county employees and equipment, and necessary costs billed to landowner/applicant, in accordance with the plan on the reverse side.
4. That only earth will be used in the construction of the entrance (no rocks, broken concrete, or other foreign material).
5. That during the construction of said entrance, Cherokee County shall take precautions to protect and safeguard the property and lives of the public.
6. That the applicant shall save Cherokee County, its Board of Supervisors and Engineer harmless and free and clear of any and all liability resulting from the construction, maintenance, use, or existence of the proposed entrance; and further agrees to indemnify the above parties for any loss incurred from the construction, maintenance, use or existence of the proposed entrance.
7. That this permit is subject to revocation by the Board of Supervisors at any time, when in the judgment of the Board it is necessary in the improvement or maintenance of the highway or for other reasonable cause.
8. Please fill this form out completely and give a detailed description of entrance location. For better identification, place orange/red flag in the fenceline at proposed location of entrance.
9. Any water conduit that is placed with the proposed entrance shall become the property of Cherokee County.
10. That entrances will be constructed as they fit with the work schedule of the County; and that construction will not interfere with the regularly scheduled maintenance of the county roads.

Property Owner's Signature

Date